



Features

- Extruded Aluminum with Metal Clad PCB for perfect thermal transfer
- Only Down Light model
- Full Glow upto edge with no hot spots and dark patches
- 1.5mtr Suspension with height adjustment.
- Inbuilt Driver.
- DALI dimming compatibility.
- CCT Tunable Option as customized solution
- Remote operated control for dimming and CCT Tuning option as customized solution

Aton Suspended

Housing Colors

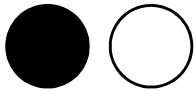

CCT – 3000K/4000K/5700K/6500K

Dimensional Drawing

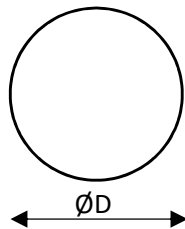
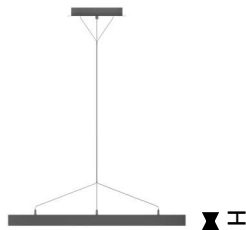

Polar Curve

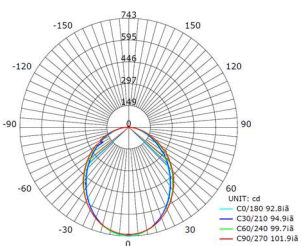

Beam Angle > 90°

Variants

Order Code	Installation	Product Size (Dia. X H)	Wattage	System Lumen	CCT & CRI	Color
DL13-PC15-1540-WHPZ	Pendant Mount	Ø345 X H80	15W	1200 Lm	4000K & 80CRI	White
DL13-PC20-3040-WHPZ	Pendant Mount	Ø600 X H80	30W	2400 Lm	4000K & 80CRI	White
DL13-PC25-4040-WHPZ	Pendant Mount	Ø750 X H80	40W	3200 Lm	4000K & 80CRI	White

For customization in CCT, CRI, Wattage, Color, Optics, Dimming, Tuning please consult before ordering.

Technical Specs

SN	Technical Parameters	Values
1	Lumen Efficacy	80 Lm/W +/- 5%
2	Illumination	100 % Down
3	Operating Ambient Temperature	10-45 °C
4	Operating Frequency	50 Hz ± 3%
5	Rated Voltage	240 V
6	Input Voltage Range	150 V – 270 V
7	IP rating	IP20
8	Construction Details	CNC Bent Aluminum Housing
9	Diffuser/Optical material	Imported HET Opal Diffuser
10	Light Source	LED
11	LED Manufacturer	Bridgelux
12	Colour Temperature (K) CCT	3000K, 4000K, 5700K, 6500K
13	Standard Deviation Colour Matching (SDCM)	3 SDCM
14	LED life with L70 criteria	50,000 Hrs.
15	Color Rendering Index	CRI > 80
16	Unified Glare Rating	UGR < 26
17	Beam Angle	> 90°
18	Driver Efficiency	>85%
19	Surge Protection (kV)	3 kV
20	PF @ Full Load & Rated Voltage	>0.95
21	THD @ Full Load & Rated Voltage	< 5 %
22	LED CCT Binning	ANSI Bin C78.377A
23	LED Photo biological safety report	IEC 62471
24	Electrical Insulation Class	Class I

For Specifiers:

Clove Make – ATON technical decorative suspended light, Ø600XH80mm, 30W, 80CRI, 4000K CCT, HET Opal Diffuser, white powder coated. System efficacy 80 Lm/W, 3 SDCM LED binning, ON-OFF switchable inbuilt driver with constant current type, THD<5%, Efficiency>85%, PF>0.95. Aluminum housing, rigid PCB with SMD connectors, and with all accessories for installation.